

Cod. D463101

White

DOP-No 997

Back to wall bowl with 4,5 L universal outlet, due to rimless system and interior surface design. Supplied with fixation set for hidden attachment. To be completed with seat and cover and outlet bend in case of vertical installation.

Width (mm)	360
Depth (mm)	550
Height (mm)	410
Weight (Kg)	34,70
Flush Volume (l)	4,5
Installation	back to wall
Outlet	universal outlet



available colours:

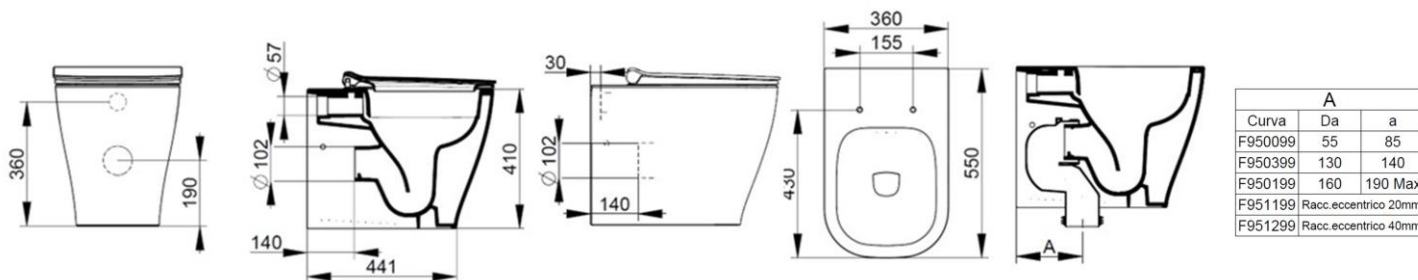
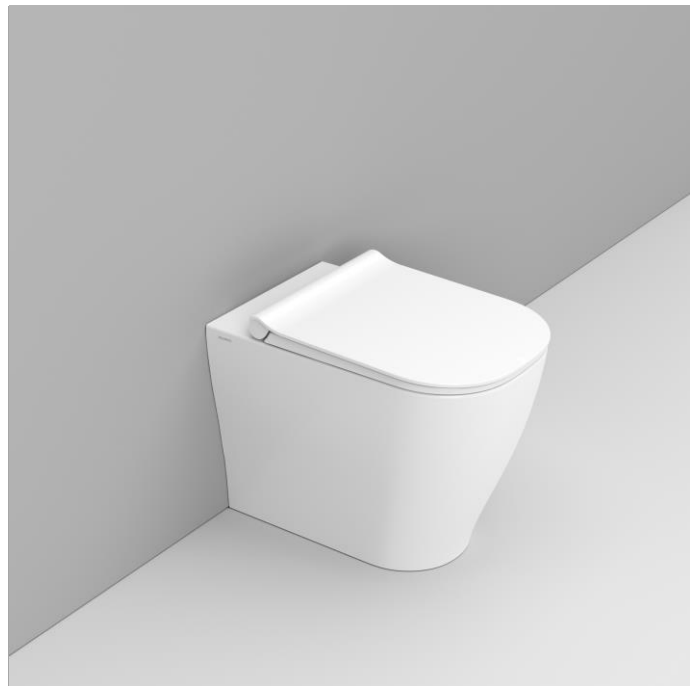

SEAT and COVER (NOT INCLUDE)



S463201

Normal closing seat and cover with metal hinges.



S463301

Soft closing seat and cover with metal hinges and quick take-off



F953299

Fixation set for hidden BTW installation

PROVIDED FIXINGS / ACCESSORIES

NOT PROVIDED FIXINGS / ACCESSORIES / SPARE PARTS

(* Mandatory)



F950399

Plastic 'S' outlet bend 90°



F950099

Plastic outlet bend 90°



F950199

Plastic outlet bend 90°, to be installed only on shifted BTW bowl



F951299

Eccentric adapter for outlet +/- 40mm.



F951199

Eccentric adapter for outlet +/- 20mm.



VS52701

Buffers kit for Mia/Mirto/Gemma2 seat and cover



VS362CR

Hinges for Mia-Mirto normal closing seat and cover.



VS363CR

Hinges for Mirto soft closing seat and cover.